

Courses on the Creek

- S 8½ W. 53
- S 10½ E 26½
- S 39½ E 20
- S 76½ E 24
- S 63½ E 12
- 135½ P.

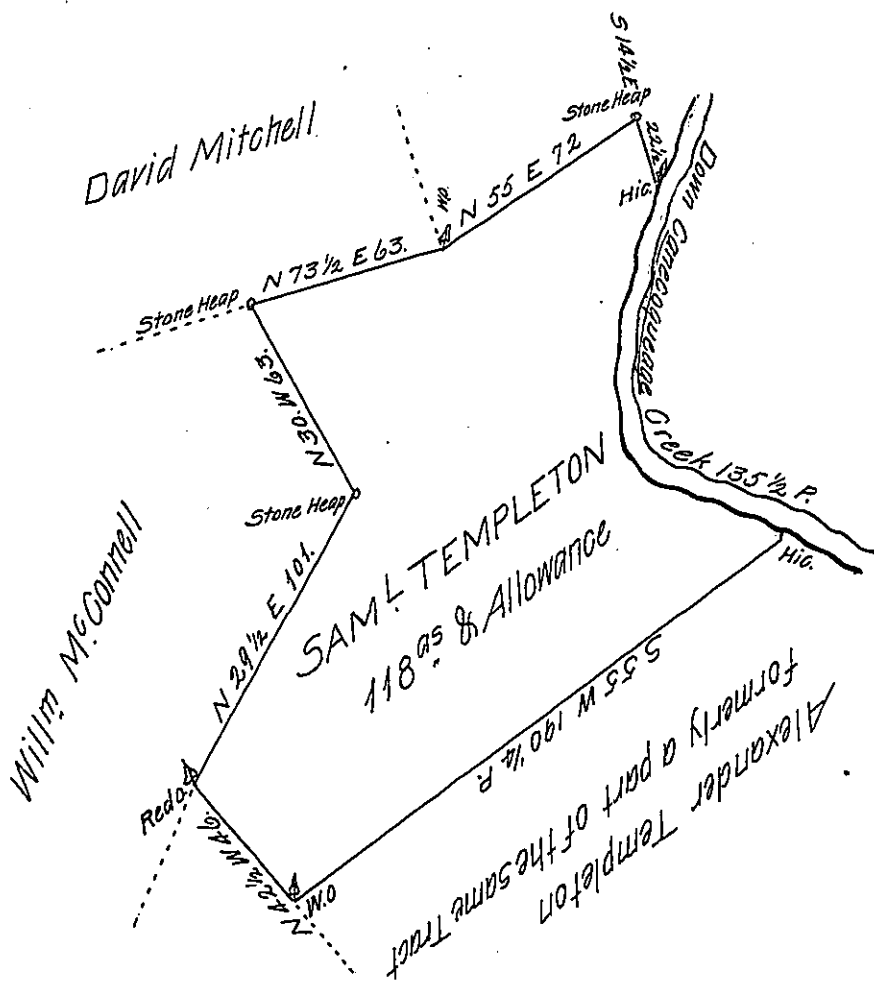

A Draft of a Tract or Parcel of Land situate in Peters Township in the County of Franklin (formerly in the County of Cumberland) Containing one hundred and eighteen Acres and being Part of a Tract of Land the Allowance of Six P. Cent for Roads &c. formerly surveyed in pursuance of the Application of Samuel Templeton No 4556 bearing Date the seventh Day of November 1767 Survey'd and laid off from the other Part of the said Tract the 18<sup>th</sup> Day of December 1791.

Matt<sup>r</sup> Henderson D.S.

To Daniel Brodhead Esquire }  
 Surveyor General of Pennsylvania }

IN TESTIMONY that the above is a copy of the original remaining on file in the Department of Internal Affairs of Pennsylvania, made conformably to an Act of Assembly approved the 16th day of February, 1833, I have hereunto set my Hand and caused the Seal of said Department to be affixed at Harrisburg, this twenty ninth day of December 1905.

*Geo. D. Brown*  
 Secretary of Internal Affairs.